

Supplemental Assembly Instructions For Lawn Stryper Generation 3

Supplemental Assembly Instructions For Lawn Stryper Generation 3

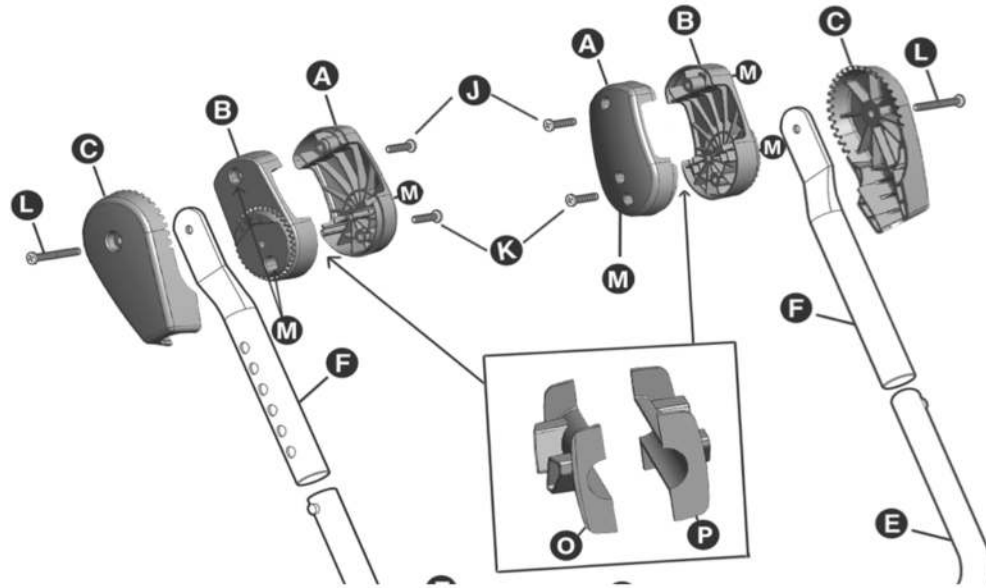

Generation 3 Inserts

- Locate the appropriate TWO (2x) bags of inserts (O & P).
 - * Refer to PAGE 5 of Owner's Manual for Mower/Insert list.
- Take ONE (1x) insert from EACH appropriate insert bag.
- Confirm proper fit by placing inserts on mower handlebars.
 - * Chosen inserts should conform to mower handlebar design.
- Using the Alignment Tic-Lines, located on the inserts and master clamps (A & B), position inserts into master clamps.
 - * Check for proper fit and that ALL Tic-Lines align.
- Repeat above for second master clamp/insert assembly.
- Continue with assembly per Owner's Manual.

Hook Assembly



- With hook bar (D) holes facing upward, slide hook through hook bar center slot.
- Place washer.
- Thread locknut onto hook threads.
- Tighten locknut until 2 to 3 threads show.
- **IMPORTANT-DO NOT OVERTIGHTEN**
- Hook should swivel left/right AND slightly slide In/Out of hook bar (D).
- Hook should ALSO rest on hook bar when turned to the right and left.

HAVE QUESTIONS OR REQUIRE ASSISTANCE - CONTACT US AT SERVICE@PATTERNYOURLAWN.COM